

 **AKIRA FLOOR**



SPC FLOORING

5MM



WITH IXPE LAYER



Environmental
friendly



Fire
retardant



Super strong
wear resistance



Super
anti-skid



Silent noise
reduction



Good thermal
conductivity



Easy
installation



A5001

MILKY WHITE

SPECIFICATION:

Size:  182 x 1220mm

Thickness / Wear Layer:  5.0mm(4+1mm IXPE)/0.2mm



A5002

GREY OAK

SPECIFICATION:

Size:  182 x 1220mm

Thickness / Wear Layer:  5.0mm(4+1mm IXPE)/0.2mm

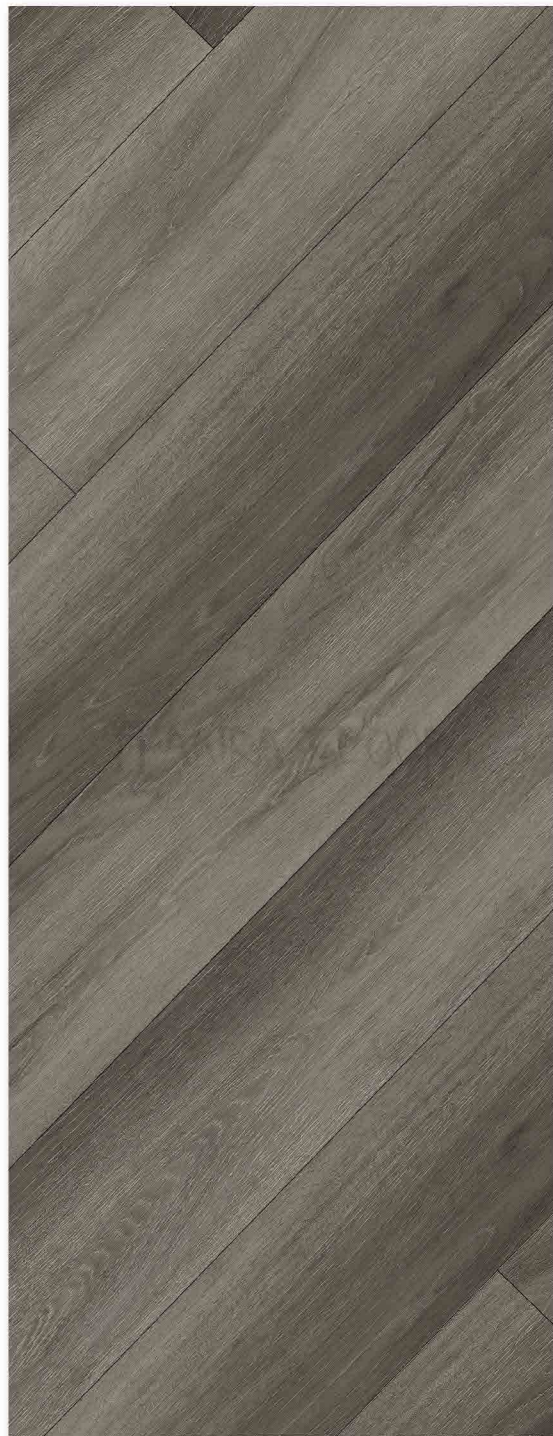

A5003

CLASSICAL WOOD

SPECIFICATION:

Size:  182 x 1220mm

Thickness / Wear Layer:  5.0mm(4+1mm IXPE)/0.2mm

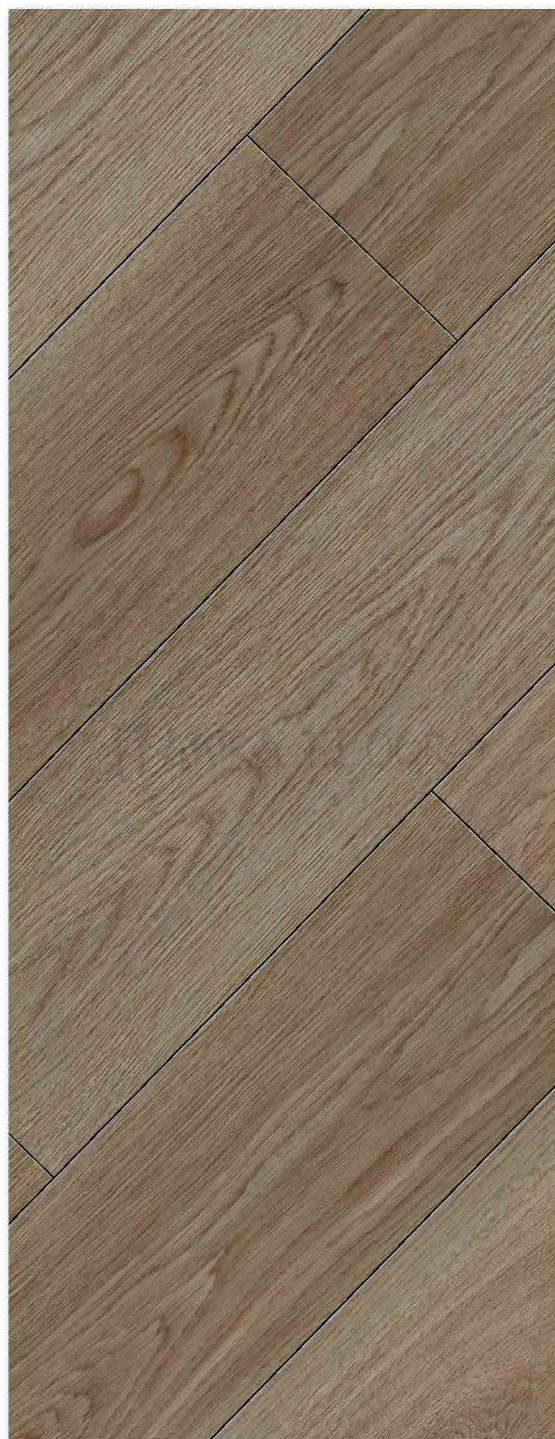

A5004

AUSTRALIAN OAK

SPECIFICATION:

Size:  182 x 1220mm

Thickness / Wear Layer:  5.0mm(4+1mm IXPE)/0.2mm

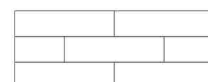



A5005

DEEP RED

SPECIFICATION:

Size:  182 x 1220mm

Thickness / Wear Layer:  5.0mm(4+1mm IXPE)/0.2mm



A5006

ASIA OAK

SPECIFICATION:

Size:  182 x 1220mm

Thickness / Wear Layer:  5.0mm(4+1mm IXPE)/0.2mm



A5007

OSMANTHUS TEAK

SPECIFICATION:

Size:  182 x 1220mm

Thickness / Wear Layer:  5.0mm(4+1mm IXPE)/0.2mm



A5008

FINE CREAM

SPECIFICATION:

Size:  182 x 1220mm

Thickness / Wear Layer:  5.0mm(4+1mm IXPE)/0.2mm



A5009

IVORY WALNUT

SPECIFICATION:

Size:  182 x 1220mm

Thickness / Wear Layer:  5.0mm(4+1mm IXPE)/0.2mm



A5010

GOLDEN MAPLE

SPECIFICATION:

Size:  182 x 1220mm

Thickness / Wear Layer:  5.0mm(4+1mm IXPE)/0.2mm

SPECIFICATION

DESCRIPTION	STANDARDS	UNIT	RESULTS
Total thickness	EN ISO 24346 (EN 428)	mm	5.0 (4+1mm IXPE)
	ASTM F386	inch	0.197
Thickness of wearlayer	EN ISO 24340 (EN 429)	mm	0.2
	ASTM F410	inch	0.007
Weight	EN ISO 23997 (EN 430)	kg/m ²	≥8
Size	EN ISO 24342 (EN 427)	mm	182x1220
	ASTM F 536	inch	7.17"x 48"
CLASSIFICATION			
Norm/Product specification	—	—	EN ISO 10582 (EN 649)
	ASTM F 1700	—	Class III Type B
European classification	EN ISO 10874 (EN 685)	class	33-42
Fire rating	EN 13 501-1	class	Bfl-s1
Static electrical propensity	EN 1815	Kv	<2
Slip resistance wet	DIN 51 130	class	R10
PERFORMANCES			
Wear Resistance	EN 660.2	mm ³	≤2.0
Wear Group	NF 189	group	T
Type Binder content	ISO 10582	group	I
Impact Sound Insulation	EN ISO 717-2	db	4
Dimensional Stability	EN ISO 23999 (EN 434)	%	≤0.15
Residual Indentation	EN ISO 24343-1 EN 433)	mm	≤0.10
Castor Chair Test	ISO 4918 EN 425)	—	OK
Thermal Conductivity	EN ISO 10456 EN 12 524)	W/{m.k}	0.25
Colour Fastness	EN 20 105-B02	degree	≥6
Special maintenance treatment	—	—	PUR+Matt
Chemical Products Resistance	EN ISO 16000- (EN 423)	—	OK
ENVIRONMENT/INDOOR AIR QUALITY			



CARA PEMASANGAN :

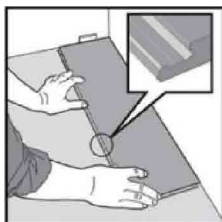

1. Letakan papan baris pertama pada sudut ruangan, posisikan papan dengan sisi lidah menempel pada dinding.

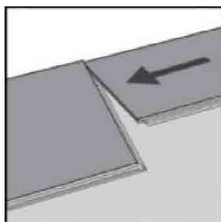

2. pada papan kedua, baris pertama, pasang papan ini dengan perlahan ke ujung sempit papan pertama.

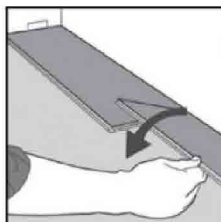

3. selama pemasangan, pastikan papan saling menempel erat, tekan dengan lembut di ujung sempit yang baru saja dipasang.

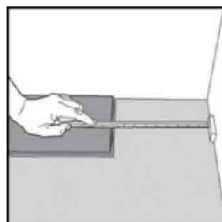

4. di akhir baris pertama sisakan celah 1/4 ke dinding dan ukur panjang papan terakhir lalu potong.

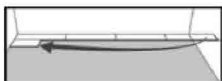

5. Taruh potongan papan sebelum di baris kedua, posisikan sudut pada tengah papan baris pertama.

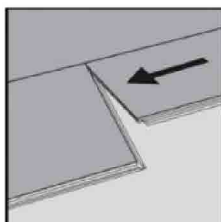

7. Pada papan kedua, di baris kedua, pasang papan perlahan-lahan ke ujung sempit papan sebelumnya.

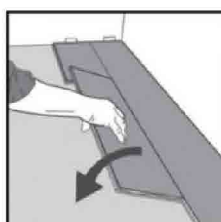

7. Pada papan kedua, di baris kedua, pasang papan perlahan-lahan ke ujung sempit papan sebelumnya.

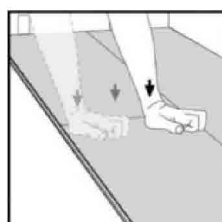

8. Tekan papan perlahan pada bagian ujung sempit pastikan terpasang dengan sempurna.

